

PLAT OF TOPOGRAPHY

OF

LOT 34 (EXCEPT THE EAST 1/2 THEREOF) IN WALTER'S RESUBDIVISION OF PART OF THE NORTHEAST 1/4 OF THE SOUTHEAST 1/4 OF SECTION 9, AND PART OF THE NORTHWEST 1/4 OF THE SOUTHWEST 1/4 OF SECTION 10, TOWNSHIP 42 NORTH, RANGE 12, EAST OF THE THIRD PRINCIPAL MERIDIAN, IN COOK COUNTY, ILLINOIS.

TOTAL LAND AREA: 19,943 SQ.FT.

COMMONLY KNOWN AS: 2120 CENTER AVENUE, NORTHBROOK, ILLINOIS 60062



SCALE: 1 INCH = 15 FEET

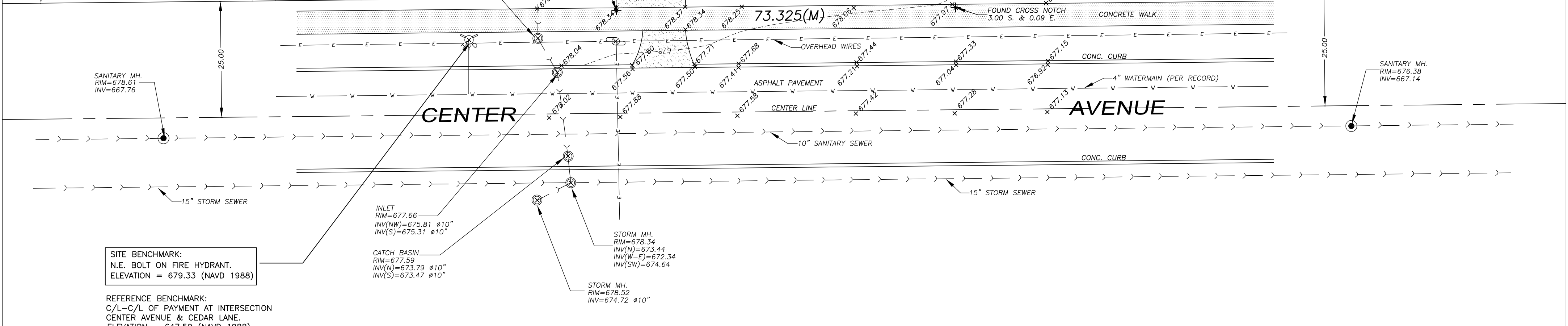

SITE BENCHMARK:
N.E. BOLT ON FIRE HYDRANT.
ELEVATION = 679.33 (NAVD 1988)

REFERENCE BENCHMARK:
C/L-C/L OF PAYMENT AT INTERSECTION
CENTER AVENUE & CEDAR LANE
ELEVATION = 647.50 (NAVD 1988)

INLET
RIM=677.66
INV(N)=675.81 #10"
INV(S)=675.31 #10"

CATCH BASIN
RIM=677.59
INV(N)=673.79 #10"
INV(S)=673.47 #10"

STORM MH.
RIM=678.34
INV(N)=675.44
INV(W-E)=672.34
INV(SW)=674.64

STORM MH.
RIM=678.52
INV=674.72 #10"

IMPERVIOUS COVERAGE (ENTIRE LOT):
GROSS LAND AREA = 19,943 SQ.FT.
HOUSE = 2009 SQ.FT.
DRIVEWAY = 961 SQ.FT.
CONC. STOOP (2) & WALK = 132 SQ.FT.
TOTAL IMPERVIOUS COVERAGE = 3102 SQ.FT. (15.55%)

LEGEND:
(R) = Record
(M) = Measured
N. = North
S. = South
W. = West
E. = East
T/F = Top of Foundation
B/S = Bottom of Siding
F.F.L. = Finish Floor
G/S = Garage Slab
TC = Top of Curb
BC = Bottom of Curb
Conc. = Concrete
Tree
Wood Power Pole
Wood Fence

NOTE: Location of underground utilities where not substantiated by physical evidence are taken from records normally considered reliable. No responsibility for their accuracy is assumed by the surveyor.
FOR LOCATION OF BURIED CABLE CALL J.U.L.I.E. @1-800-892-0123 BEFORE DIGGING

NOTE: 15" SNOW COVER AT TIME OF SURVEY.

ORDER NO.: 14-025
ORDERED BY: LS CONSTRUCTION

PREPARED BY:
GEODETIC SURVEY, LTD.
PROFESSIONAL DESIGN FIRM NO. 184-004394
CONSTRUCTION AND LAND SURVEYORS
1121 DEPOT STREET, GLENVIEW, IL 60025
TEL. (847) 904-7690; FAX (847) 904-7691

STATE OF ILLINOIS SS
COUNTY OF COOK

THIS PROFESSIONAL SERVICE CONFORMS TO THE CURRENT ILLINOIS MINIMUM STANDARDS FOR TOPOGRAPHIC SURVEYS.

FIELD WORK COMPLETED: FEBRUARY 12, 2013
DATED THIS 13th DAY OF FEBRUARY, 2013.

By: *Thomas R. Groh*
PROFESSIONAL ILLINOIS LAND SURVEYOR NO. 3000
LICENSE EXPIRES 11/30/2014

